

NOTES:

- 1. INTERFACE PER MIL-STD-348.
- 2. HERMETIC LEAK RATE:  $\leq 1 \times 10^{-9}$  CC/SEC He @ 1 ATM. DIFF.
- 3. IMPEDANCE: 50 OHMS NOMINAL
- 4. INSERT PLATING: Ni PLATE PER AMS-QQ-N-290, .000100/.000250 THICK.  
GOLD PLATE PER ASTM-B488, TYPE III CODE A, .000050/.000150 THICK.
- 6. ORDERING INFORMATION, PLEASE SPECIFY ACCORDING TO THE FOLLOWING.  
IDENTIFY WITH BASE PART No., DETENT TYPE, SHELL MATERIAL, AND DIMENSION "A" LENGTH.

EXAMPLE:

921-00003 - FD - FD - AL2

SHELL MATERIAL  
AL2 = ALUMINUM 4032  
AL7 = ALUMINUM 4047  
SST = STAINLESS 304L  
TI = TITANIUM GRADE 2

DETENT TYPE, TRANSITION SIDE  
SB = SMOOTH BORE  
LD = LIMITED DETENT  
FD = FULL DETENT

DETENT TYPE, SOLID SIDE  
SB = SMOOTH BORE  
LD = LIMITED DETENT  
FD = FULL DETENT

BASE PART No.

7. MATERIALS:

INSERT: KOVAR ASTM-F15

WELD FLANGE OPTIONS:  
- ALUMINUM 4032  
- ALUMINUM 4047  
- STAINLESS 304L  
- TITANIUM GRADE 2

CONTACT: KOVAR ASTM-F15

INSULATOR: 7070 GLASS

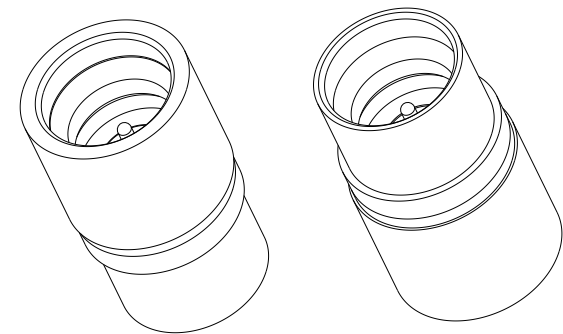
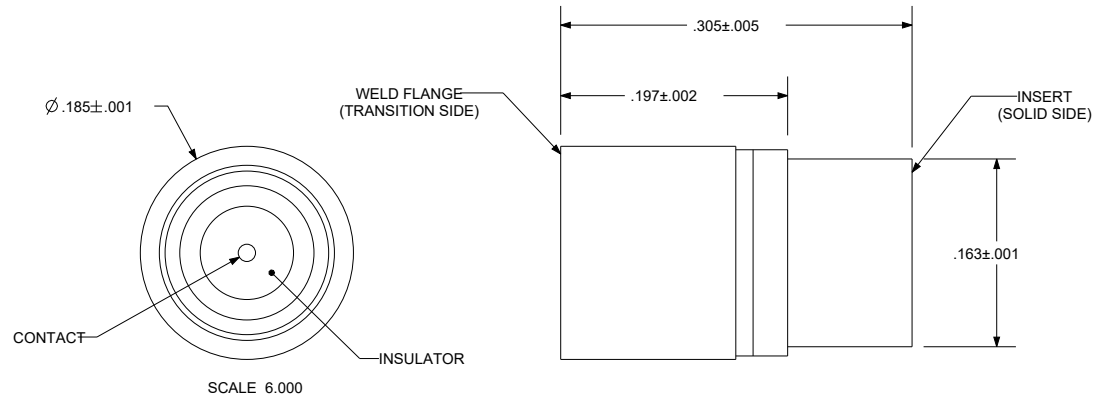

SCALE 5.000

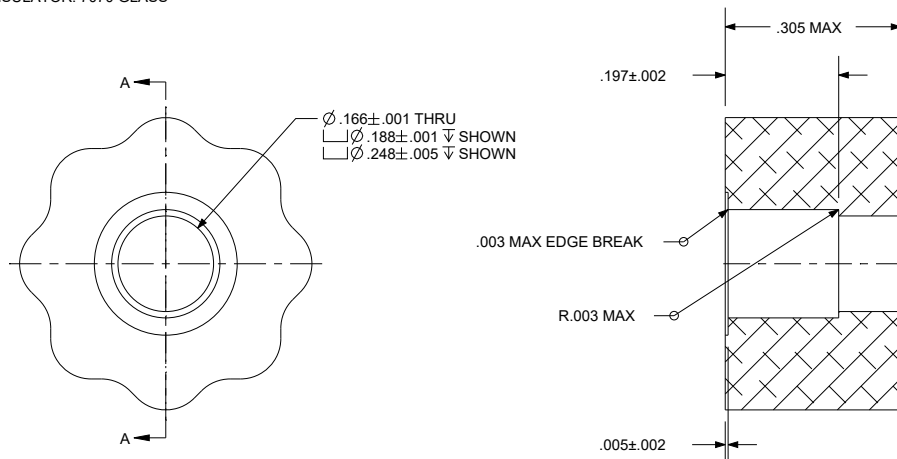

SCALE 3.000

SECTION A-A

HOLE DETAIL

**PACAE** Pacific Aerospace & Electronics, Inc  
434 Olds Station Rd. Wenatchee, Washington 98801  
[WWW.PACAERO.COM](http://WWW.PACAERO.COM)

TITLE: CONNECTOR, SMP/SMP, LASER WELD

THIRD ANGLE PROJECTION

J/C:

VERSION <b>B.0</b>	RELEASE DATE: <b>05-16-19</b>	CAGE CODE:	SCALE: 6.000	SHEET: 1 OF 1	DOCUMENT: 0-921-00003
-----------------------	----------------------------------	------------	-----------------	------------------	--------------------------

SALES DRAWING