

REVISION HISTORY				
ZONE	REV	DESCRIPTION	DATE	APPROVED
	5	ADD NEW P/N AND PIM >160	5/6/2025	MA

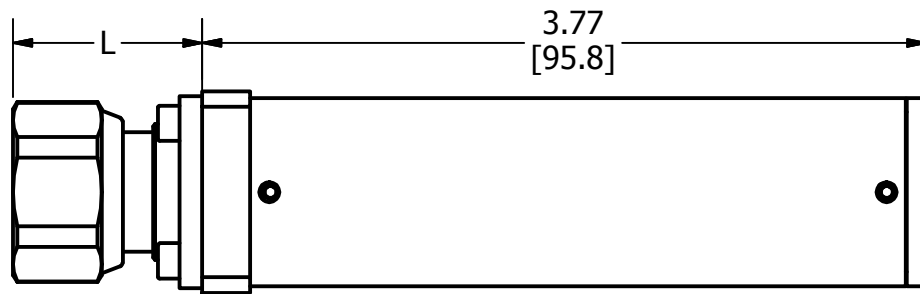
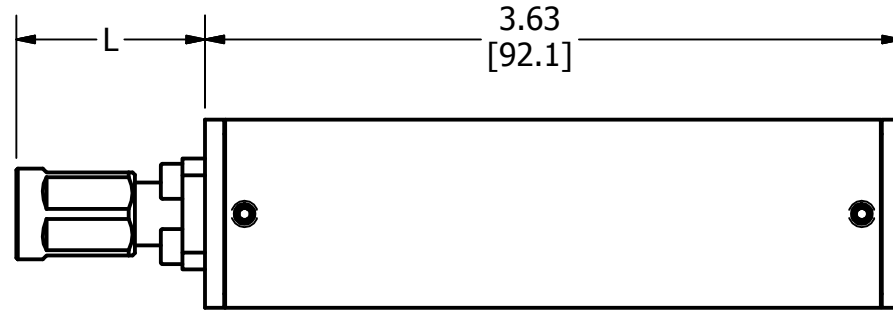
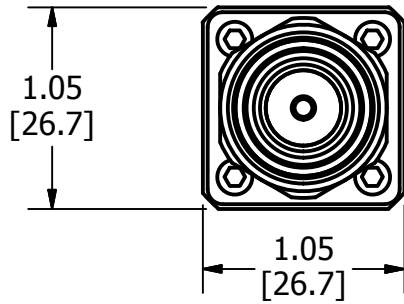
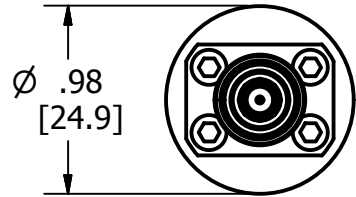

VIEW 1

VIEW 2

POWER: 20 WATTS MAX 0.6-2 GHz
 10 WATTS MAX 2-6 GHz
 RETURN LOSS: 20 dB, 600-6000 MHz
 PIM: 160 dBc @ 1900 MHz
 CONNECTOR: SEE TABLE

NOTE: FOR IP66 ENVIRONMENTAL SEALING, ADD '-E' TO PART NUMBER

CONNECTOR SELECTION

P/N	TYPE	L (in)	VIEW
TA-A99NXM	NEX10(m)	.98	1
TA-A99NXF	NEX10(f)	.74	1
TA-A99D22M	2.2-5.0(m)	.96	1
TA-A99D22F	2.2-5.0(f)	.87	1
TA-A99D43M	DIN 4.3-10(m)	.98	2
TA-A99D43F	DIN 4.3-10(f)	1.12	2
TA-A99NM	N(m)	.73	2
TA-A99NF	N(f)	.74	2
TA-A99DM	DIN 7-16(m)	1.20	2
TA-A99DF	DIN 7-16(f)	1.24	2

DRAWN mclaughlind	9/29/2023
ALL DIMENSIONS DERIVED FROM THE ELECTRONIC FILE ON THE SAME PLANE SHOULD BE WITHIN ±0.005 FROM TRUE POSITION, UNLESS OTHERWISE NOTED	
PROPERTY OF R&D MICROWAVES LLC	

TITLE 20W TERMINATION		
SIZE A	DWG NO TA-A99-OLrev5	REV 5
SCALE 1:1	SHEET 1 OF 1	