

Common Specifications	
Frequency:	380 - 6000 MHz (1)
Passive Intermodulation: (2 x 43 dBm Carrier @ 1900 MHz)	< -160 to -165 dBc Typical
Power Range:	2 - 250 Watts
Connectors:	7-16 DIN, 4.3-10, Type N, or NEX10 (female or male)
Load Type:	Low PIM cable, open circuit (DC return optional on some models)

(1) Return Loss: See individual specsheets - Typically 20-25 dB

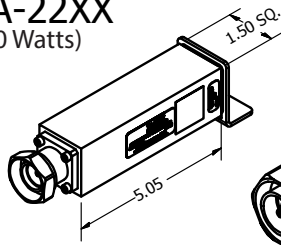

**TA-22XX**  
(20 Watts)



**TA-2XX**  
(Not PIM rated)  
(2 Watts)

\*Available for 7/16 DIN, 4.3-10, and Type N male only

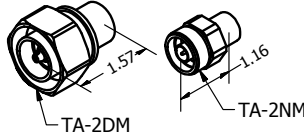

**TA-5XX**  
(Not PIM rated)  
(5 Watts)

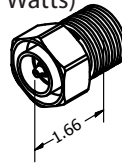

**TA-A40XXCB**  
(40 Watts)

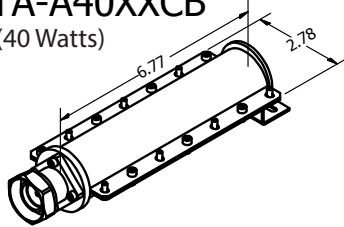

**TA-A85XX**  
(10 Watts)

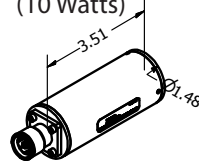

**TA-A60XXCBE**  
(60 Watts)

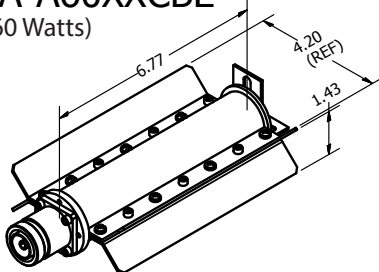

**TA-A19XX-B**  
(100 Watts)

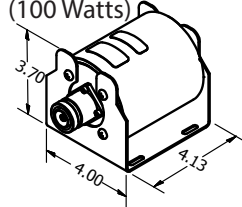

**TA-A20XX**  
(150 Watts)

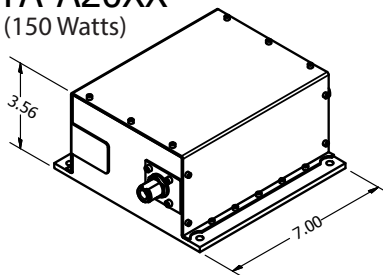

**TA-A100XX**  
(100 Watts)

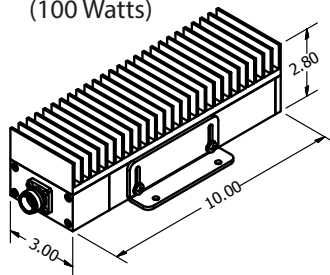

Power (Watts)	Model	Package Type
2	TA-2XX*	Cylinder
5	TA-5XX	Cylinder
10	TA-A85XX	Spool-Cylinder
20	TA-22XX	Rectangular
40	TA-A40XXCB	Spool-Cylinder
50	TA-A54XX	Rod
60	TA-A60XXCBE	Sealed Cylinder
60	TA-A41DF	Cylinder
100	TA-A100XX	Rectangular Finned
100	TA-A19XX-B	Cylinder in Bracket
100	TA-A66XX	Low Profile, Finned
150	TA-A61XX	Rectangular
150	TA-A20	Rectangular
250	TA-A50XX-(50DC)	Rectangular Finned

### Typical Model

**TA-A40XX**  
SERIES  
CONNECTOR ID

Connectors*:	Connector ID
7-16 DIN Male	DM
7-16 DIN Female	DF
Type N Male	NM
Type N Female	NF
4.3-10 DIN Male	D43M
4.3-10 DIN Female	D43F
NEX10 Male	NXM
NEX10 Female	NXF

\*Not all connectors are available on all models

**TA-A50XX-(50DC)**  
(250 Watts)

