

# DESCRIPTION

THE MODEL P8T-6G8G-90-T-55-SFF-DEC IS A HIGH SPEED, SINGLE POLE, EIGHT THROW, ABSORPTIVE SWITCH CAPABLE OF SWITCHING WITHIN 30nSEC. THE FREQUENCY RANGE IS 6 TO 8 GHz AND THIS SWITCH HAS OVER 90dB OF ISOLATION.

# SPECIFICATIONS

- FREQUENCY RANGE: 6 TO 8 GHz
- ISOLATION 90dB MIN
- INSERTION LOSS 4.0dB MAX, 3.5dB TYP
- VSWR IN/OUT 2.0:1 MAX
- OPERATING INPUT POWER +20dBm CW
- SWITCHING SPEED 30 ns MAX
- DC VOLTAGE AND CURRENT +5VDC @ 400mA  
-5VDC @ 100mA
- CONTROL SIGNAL 3 Bit DECODED TTL
- CONNECTORS SMA (F)
- FINISH GOLD PLATED
- SIZE 4.0" X 1.5" X 0.4"

# ENVIRONMENTAL RATINGS

- TEMPERATURE: -54°C TO +95°C (OPERATING)  
-65°C TO +125°C (STORAGE)
- HUMIDITY: MIL-STD-202F, METHOD 103B COND. B
- SHOCK: MIL-STD-202F, METHOD 213B COND. B
- VIBRATION: MIL-STD-202F, METHOD 204D COND. B
- ALTITUDE: MIL-STD-202F, METHOD 105C COND. B
- TEMPERATURE CYCLE: MIL-STD-202F, METHOD 107D COND. A

NOTE: SPECIFICATIONS WILL VARY OVER OPERATING TEMPERATURE  
NOTE: THE ABOVE SPECIFICATIONS ARE SUBJECT TO CHANGE OR REVISION

ALL DIMENSIONS ARE IN INCHES  
TOLERANCES:  
X.XX ±0.020  
X.XXX ±0.010  
WEIGHT: 2.75 oz.

| REVISIONS |      |             |         |          |
|-----------|------|-------------|---------|----------|
| ZONE      | REV. | DESCRIPTION | DATE    | APPROVED |
|           | -    | PRELIMINARY | 8/11/21 |          |

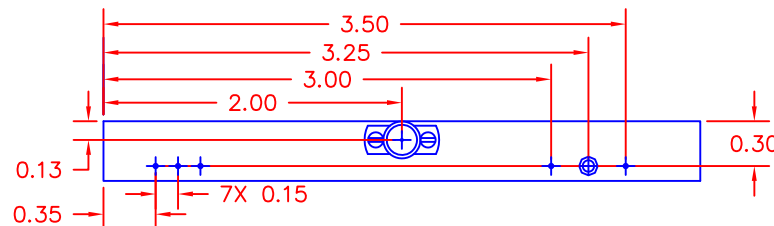
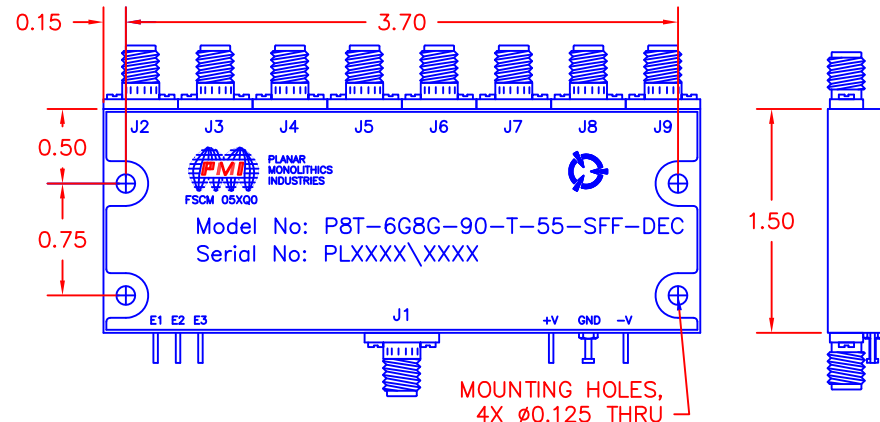
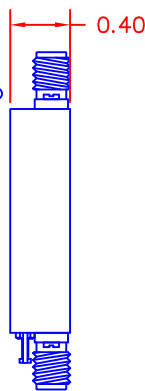
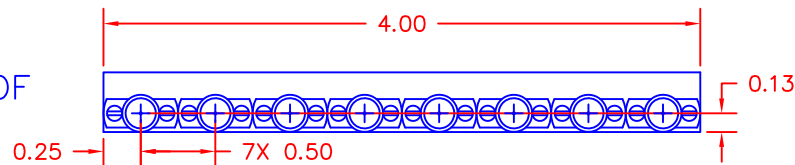

## PLANAR MONOLITHICS INDUSTRIES, INC.

7311-F GROVE ROAD  
FREDERICK, MARYLAND 21704 USA  
TEL: 301-662-5019 FAX: 301-662-1731  
WEBSITE: [www.pmi-rf.com](http://www.pmi-rf.com)  
E-MAIL: [sales@pmi-rf.com](mailto:sales@pmi-rf.com)  
ISO 9001:2000 CERTIFIED



| APPROVALS       |          | DATE    | TITLE                                |        |  |
|-----------------|----------|---------|--------------------------------------|--------|--|
| DRAWN <i>AF</i> |          | 8/11/21 | PRODUCT FEATURE                      |        |  |
| CHECKED         |          |         | P8T-6G8G-90-T-55-SFF-DEC             |        |  |
| ISSUED          |          |         | 6 TO 8 GHz HIGH SPEED SWITCH 8 THROW |        |  |
| SIZE            | FSCM NO. | DWG NO. | REV.                                 |        |  |
| A               | 05XQ0    |         | -                                    |        |  |
| SCALE N:S       |          | SHEET   |                                      | 1 OF 1 |  |