

SPECIFICATIONS:

- BANDREJECT FILTER

- CENTER OF NOTCH: 192.5 MHz
- PASSBAND: 30 TO 1000 MHz
- 3dB BANDWIDTH: 9 MHz

- REJECTION: @ 188.5 MHz <-30dB
- REJECTION: @ 196.5 MHz <-30dB

- PASSBAND RIPPLE: 0.25 dB
- INPUT VSWR: 2.1:1
- INPUT/OUTPUT IMPEDANCE: 50 OHMS
- INSERTION LOSS: <1.5 dB

- INPUT POWER: 5 WATTS
- SIZE: 2.500(L) x 1.250(W) x 1.250(H) EXCLUDING CONNECTORS
- WEIGHT: 3.7 OZ. TYP.

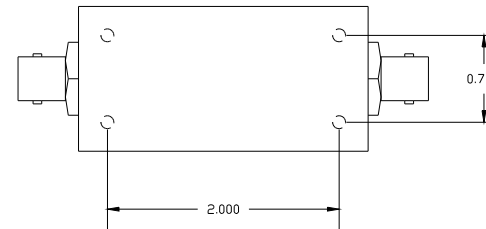
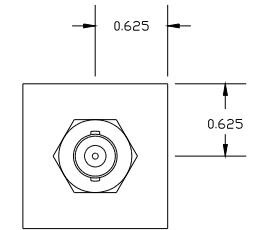
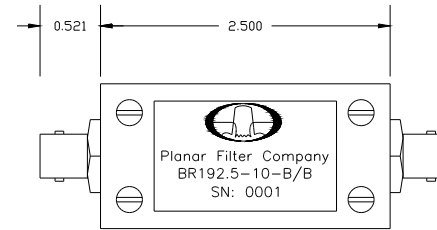
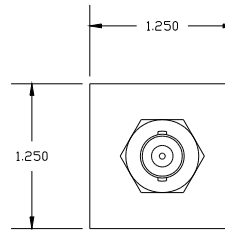

REVISIONS				
ZONE	REV.	DESCRIPTION	DATE	APPROVED
	-	ORIGINAL RELEASE	8/18/99	

ALL DIMENSIONS ARE IN INCHES
 TOLERANCES:
 X.XX ±0.010
 X.XXX ±0.005

NOTE: THE ABOVE SPECIFICATIONS ARE SUBJECT TO CHANGE OR REVISION

PART NO.		PLANAR FILTER COMPANY 7311G GROVE RD., FREDERICK, MARYLAND			
APPROVALS		DATE	TITLE		
DRAWN F. HOYOS		9/21/99	OUTLINE DRAWING BR192.5-10-B/B		
CHECKED					
ISSUED			SIZE A	FSCM NO. OZXZ8	DWG NO. HOUSING
			SCALE N/A		REV. -
				SHEET	1 OF 1