

DESCRIPTION:

PMI MODEL NUMBER PEC-20M3G-8T-SFGM-LV IS A SINGLE POLE, EIGHT THROW NON-REFLECTIVE SWITCH DESIGNED TO OPERATE OVER THE 20MHZ TO 3.0GHZ THS MODEL OFFERS ULTRA LOW VIBED TRANSIENTS.

REVISIONS				
ZONE	REV.	DESCRIPTION	DATE	APPROVED
	A1	ORIGINAL RELEASE	10/20/08	
	B1	SPECS UPDATE	3/29/11	
	B2	ECN # 13-0120	08/20/13	
	B3	ECN # 21-0152	09/17/21	

SPECIFICATIONS:

- OPERATING FREQUENCY: 20 MHz TO 3.0 GHz
- INSERTION LOSS (0.02 - 1.0GHz): 2.0dB MAXIMUM
- INSERTION LOSS (1.0 - 2.0GHz): 2.5dB MAXIMUM
- INSERTION LOSS (2.0 - 3.0GHz): 4.0dB MAXIMUM
- VSWR (0.02 - 1.0GHz): 1.8:1 MAXIMUM
- VSWR (1.0 - 2.0GHz): 1.9:1 MAXIMUM
- VSWR (2.0 - 3.0GHz): 2.0:1 MAXIMUM
- ISOLATION (0.02 - 1.0GHz): 70dB MINIMUM
- ISOLATION (1.0 - 2.0GHz): 60dB MINIMUM
- ISOLATION (2.0 - 3.0GHz): 50dB MINIMUM
- P1dB (0.02 - 1.0GHz): +23/25 dB
- P1dB (1.0 - 2.0GHz): +27/29 dB
- P1dB (2.0 - 3.0GHz): +30/32 dB
- AMPLITUDE BALANCE: +/-0.25dB
- PHASE BALANCE: +/-6.0 DEGREES
- VIBED TRANSIENTS: ABOVE 20MHZ -100 dBm
BELOW 20MHZ -75 dBm
- CONTROL: SEE TRUTH TABLE ABOVE
PINS CTL1 thru CTL3 ARE PULLED LOW '0'
- POWER SUPPLY: +5V @ 450mA NOMINAL
-12V @ 350mA NOMINAL
- RF CONNECTORS: GPO MALE
- FINISH: SILVER PLATED

TRUTH TABLE

TTL1	TTL2	TTL3	PATH
0	0	0	J9-J1
0	0	1	J9-J2
0	1	0	J9-J3
0	1	1	J9-J4
1	0	0	J9-J5
1	0	1	J9-J6
1	1	0	J9-J7
1	1	1	J9-J8

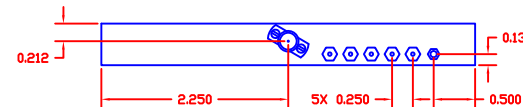
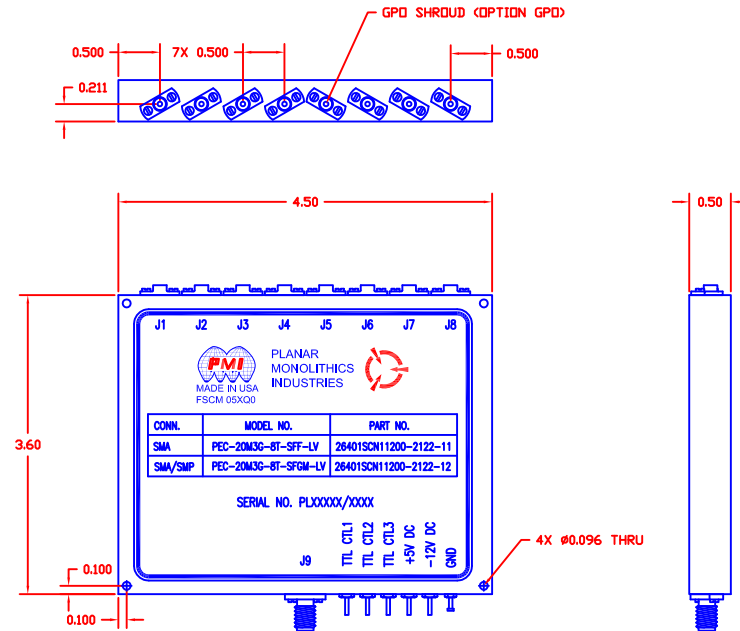

ENVIRONMENTAL RATINGS:

- TEMPERATURE: -45°C TO +90°C (OPERATING)
-54°C TO +125°C (STORAGE)
- HUMIDITY: MIL-STD-202F, METHOD 103B COND. B
- SHOCK: MIL-STD-202F, METHOD 213B COND. C
- VIBRATION: MIL-STD-202F, METHOD 204D COND. B
- SALT FOG: MIL-STD-202F, METHOD 101D+EST COND. B
- FUNGUS: MIL-STD-810F, METHOD 508.5
- EMI / EMC: MIL-STD-461E

Note: Environmental testing and ESS will be met, but actual testing is not done by PMI Actual screening is available for an additional charge.

NOTE: THE ABOVE SPECIFICATIONS ARE SUBJECT TO CHANGE OR REVISION

PMI CONFIDENTIAL AND PROPRIETARY

PLANAR MONOLITHICS INDUSTRIES, INC.
 7311-F GROVE ROAD
 FREDERICK, MARYLAND 21704 USA
 TEL: 301-662-5019 FAX: 301-662-1731
 WEBSITE: www.pmi-rf.com
 E-MAIL: sales@pmi-rf.com
 ISO 9001 CERTIFIED



ALL DIMENSIONS ARE IN INCHES
 TOLERANCES:
 XXX ±0.020
 XXXX ±0.010

APPROVALS		DATE		TITLE	
DRAWN	<i>SPD</i>		10/20/08	PRODUCT FEATURE PEC-20M3G-8T-SFGM-LV	
CHECKED		SIZE	FROM NO.	DWG NO.	REV.
ISSUED		A	05XQ0	27004805-B	B3
SCALE N: S				SHEET 1 OF 1	