

Description:

Model Number: PD-CD-001-1 is a 4 Way Phase Divider with 0°, 90°, 180°, and 270° as Phase Shift on 4 outputs. It operates at a Frequency band of 9.3 to 9.9 GHz.

Specifications:

Frequency Range:	9.3 to 9.9 GHz
Phase Balance:	±7° Max.
Amplitude Balance:	±0.5 dB Max
Insertion Loss:	8.0 dB Max
Power Input:	28 Watt cw, 750 Watt peak (1.5 kW Goal)
VSWR Input/Output:	1.5:1 Typ. 2.0:1 Max.
Impedance:	50 Ω
Dimensions:	(L) 2.35" x (W) 1.7" x (H) 0.5"
Connectors In/Out:	SMA Female
Finish:	Painted Gray

Environmental Ratings:

Temperature:	-32°C to +77°C (Operating) -65°C to +125°C (Storage)
Vibrations:	MIL-STD-202G, METHOD 204D COND C.
Shock:	MIL-STD-202G, METHOD 213B COND C.

Note: The above specifications are subject to change or revision.

REVISIONS				
ZONE	REV.	DESCRIPTION	DATE	APPROVED
	A	ORIGINAL RELEASE	04/07/11	

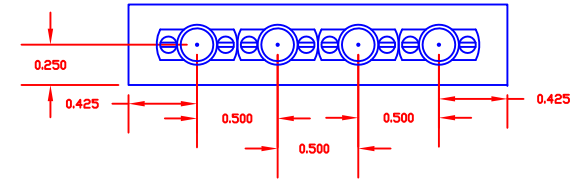

SMA Female Connector
5 Places

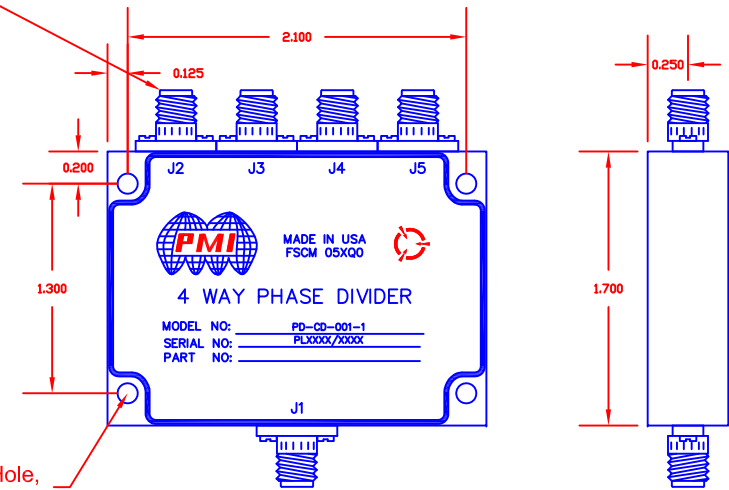

Ø.125 Thru Hole,
4 Places

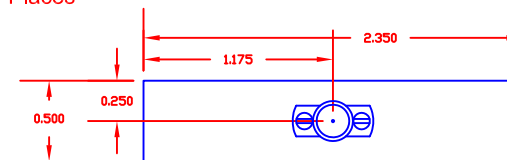

PLANAR MONOLITHICS INDUSTRIES, INC.

FREDERICK, MARYLAND 21704 USA
 TEL: 301-662-5019 FAX: 301-662-1731
 WEBSITE: www.pmi-rf.com
 E-MAIL: sales@pmi-rf.com
 ISO 9001:2000 CERTIFIED



ALL DIMENSIONS ARE IN INCHES
 TOLERANCES:
 X.XX ±0.010
 X.XXX ±0.005

APPROVALS		DATE	TITLE			
DRAWN <i>fk</i>		04/07/11	PRODUCT FEATURE PD-CD-001-1			
CHECKED			SIZE	FSCM NO.	DWG NO.	REV.
			A	05XQ0	27014041	A
ISSUED			SCALE N: S		SHEET 1 OF 1	