

REVISIONS				
ZONE	REV.	DESCRIPTION	DATE	APPROVED
	A1	ORIGINAL RELEASE	8/14/03	

Approved and Accepted By Rodelco:

\_\_\_\_\_  
Please Print and Sign Name Above

\_\_\_\_\_  
Date

Markings:  
Metal Case Gold Plated, No Paint or Markings.

Connectors:  
SMA(F) Replacable

Weight:  
55 grams (1.94oz) Max.

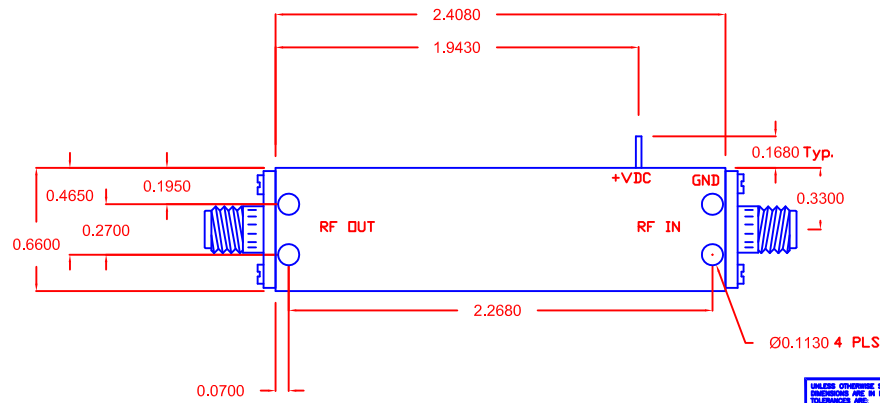
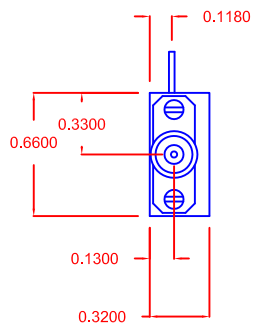
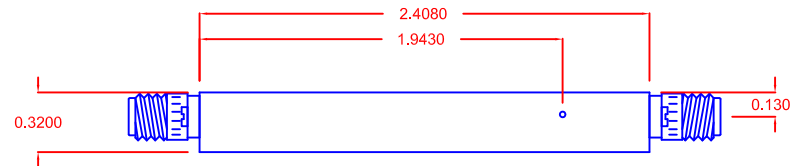
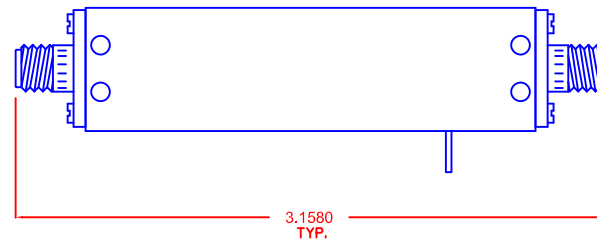

UNLESS OTHERWISE SPECIFIED DIMENSIONS ARE IN INCHES TOLERANCES ARE: FRACTIONS DECIMALS ANGLES JOINTS SURF. FINISH		PART NO.		APPROVALS		DATE		TITLE	
MATERIAL: ALUMINUM ALLOY 6061-T6		DRAWN: JCM		CHECKED:		8/14/03		PLANAR MONOLITHICS INDUSTRIES 7311-F GROVE RD. FREDERICK, MARYLAND	
FINISH: 50 u in MIN GOLD PLATE OVER COPPER FLASH, NICKEL FLASH, MIL. G. 45204 TYPE 2		USED ON:		REVIEWED:				PEC-38-818-10-15-SFF Mechanical Drawing	
APPLICATION		DO NOT SCALE DRAWING		SCALE: N/S		SHEET 1 OF 1		REV. A1	