

**DESCRIPTION:**

PFC model number 5CL7G-700-CD-SFM is a Combine filter with SMA female connectors in and out. All filters will be machined and silver plated to provide the highest possible Q.

REVISIONS				
ZONE	REV.	DESCRIPTION	DATE	APPROVED
	-	ORIGINAL RELEASE	7/10/01	

**SPECIFICATIONS:**

- CENTER FREQUENCY: 7 GHz
- 3dB BANDWIDTH: 700 MHz
- VSWR IN THE PASS BAND: 1.5:1 MAX.
- INSERTION LOSS (PASSBAND): <= 1.5 dB MAX.
- REJECTION: 8 POLE RESPONSE

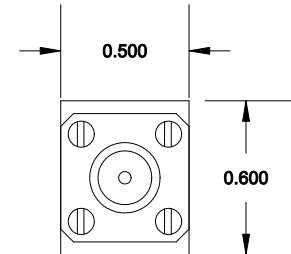
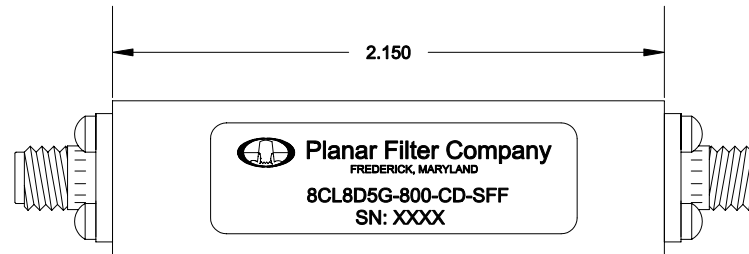

- CONNECTORS: SMA FEMALE/MALE CONNECTORS
- SIZE: 2.15" (L) x 0.60" (W) x 0.50" (H)
- WEIGHT: 1 OZ. TYP.

**ENVIRONMENTAL RATINGS:**

- TEMPERATURE: -55°C TO +85°C (OPERATING)  
-65°C TO +125°C (STORAGE)
- HUMIDITY: MIL-STD-202F, METHOD 103B COND. B
- SHOCK: MIL-STD-202F, METHOD 213B COND. B
- VIBRATION: MIL-STD-202F, METHOD 204D COND. B
- ALTITUDE: MIL-STD-202F, METHOD 105C COND. B
- SALT FOG: MIL-STD-202F, METHOD 107D COND. A
- FUNGUS: MIL-STD-810C, METHOD 508.2
- TEMPERATURE CYCLE: MIL-STD-202F, METHOD 107

ALL DIMENSIONS ARE IN INCHES  
TOLERANCES:  
X.XX ±0.010  
X.XXX ±0.005

NOTE: THE ABOVE SPECIFICATIONS ARE SUBJECT TO CHANGE OR REVISION

PART NO. 155-0991		<b>Planar Filter Company</b> 7311G Grove Road, Fredrick, Maryland		
APPROVALS	DATE	TITLE		
DRAWN S. PALACIO	7/10/01	OUTLINE DRAWING 5CL7G-700-CD-SFM		
CHECKED		SIZE	FSCM NO.	DWG NO.
ISSUED		A	1QJWO	155-0991
		SCALE	N/A	SHEET 1 OF 1