

2



1

REVISION HISTORY				
ZONE	REV	DESCRIPTION	DATE	APPROVED
	6	UPDATED PIM SPECIFICATION	9/21/2023	DM
	7	ADDED 6000-8000 MHz BAND, SMA OPTION	1/23/2025	DM
	8	INCREASED MAX POWER TO 20W ADDED NOTE FOR 7-16 CONNECTOR	2/11/2025 3/20/2026	DM DM

B

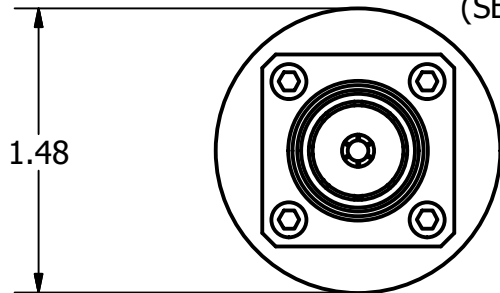

(SEE CONNECTOR TABLE)

4.3-10 (f)  
SHOWN

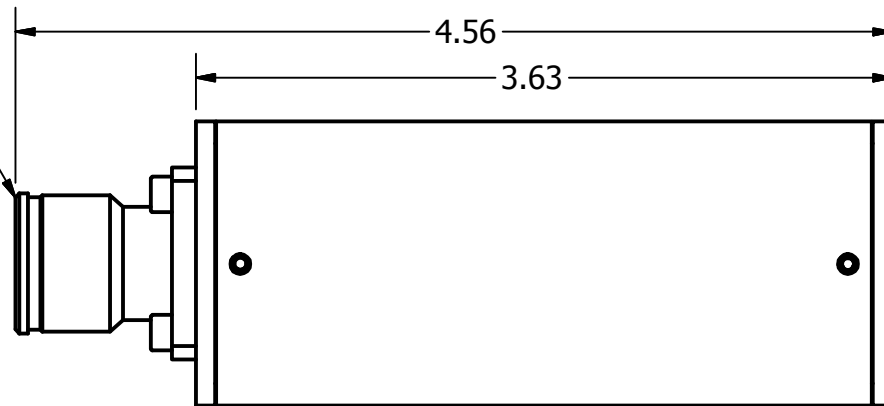

B

CONNECTOR				
(4.3-10)	(7-16 DIN)	(TYPE N)	(NEX10)	(SMA)
TA-A85D43M	TA-A85DM	TA-A85NM	TA-A85NXM	TA-A85SM
TA-A85D43F	TA-A85DF	TA-A85NF	TA-A85NXF	TA-A85SF

POWER: 0 - 20 WATTS  
 VSWR (RETURN LOSS):  
 270-400MHz: 1.25:1 (19dB) MAX  
 400-1700MHz: 1.18:1 (22dB) MAX  
 1700-6000MHz: 1.25:1 (19dB) MAX  
 6000-8000MHz\*: 1.35:1 (16.5dB) MAX  
 PIM: 165dBc

\*7-16 DIN CONNECTOR VERSION  
 NOT RATED OVER 6000MHz

PROPERTY OF R&D MICROWAVES LLC

A

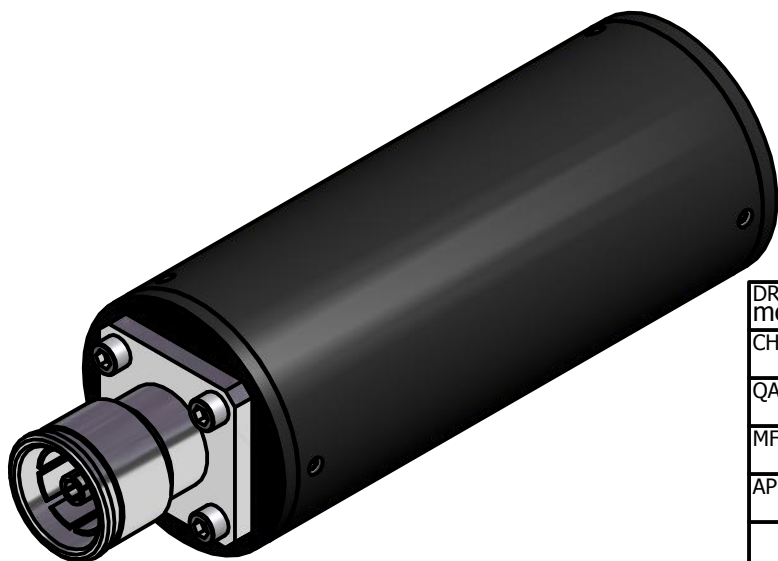

NOTE: FOR IP66 ENVIRONMENTAL SEALING,  
 ADD '-E' TO PART NUMBER

DRAWN mclaughlind	10/31/2017		R&D Microwaves LLC, USA	
CHECKED			TITLE	
QA		TA-A85, TERMINATION		
MFG		SIZE A	DWG NO TA-A85-OLrev8	REV 8
APPROVED		SCALE 1:1	SHEET 1 OF 1	

A

2



1