



### Features and Benefits

Frequency range: 25.24MHz  
Supply voltage: 3.3V  
Steady current: 20mA Max  
Output waveform: Sinewave  
Frequency stability vs. operating temperature:  $\pm 1$ ppm  
Aging:  $\pm 1.0$ ppm per year  
Operating temperature:  $-40^{\circ}\text{C}$  to  $+85^{\circ}\text{C}$   
Size: 18.3x11.7x7.0mm

### Typical Applications

UHF Synthesizers  
SATCOM System  
Portable Microwave Applications

### Mechanical Drawing & Pin Connections

Drawing No: MD200059-1

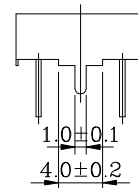
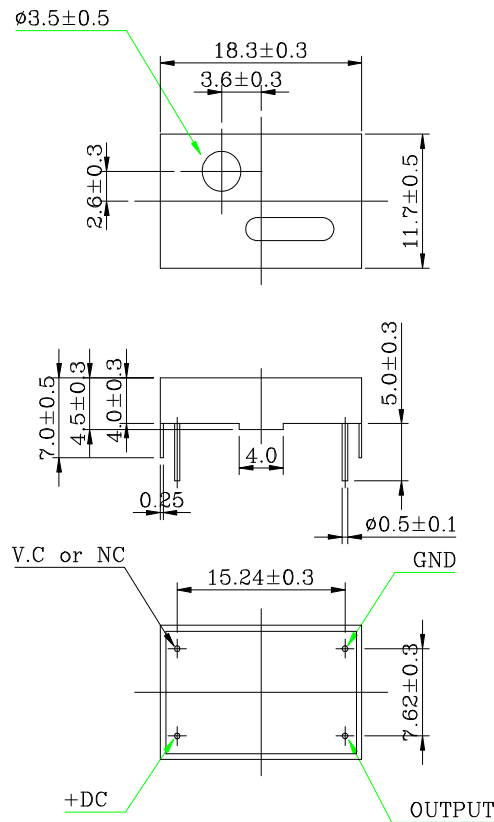



**Specifications**

Oscillator Specification	Sym	Condition	Value			Unit	Note
			Min.	Typ.	Max.		
Operational Frequency	f <sub>0</sub>			25.24		MHz	
<b>RF Output</b>							
Sine wave	Level		0			dBm	
	Load			50		Ohm	
<b>Power Supply</b>							
Voltage	V <sub>cc</sub>	±5%		3.3		V	
Current					20	mA	
<b>Frequency Control</b>							
Control Voltage Range		+/-1.35V		1.65		V	
Frequency Deviation			±10			ppm	
Linearity					±10	%	
Frequency adjustment		By internal trimmer	±3			ppm	
<b>Frequency Stability</b>							
Vs. Temperature		-40°C to +85°C			±1.0	ppm	
Vs. Supply Voltage		±5%			±0.2	ppm	
Vs. Load		±10%			±0.2	ppm	
Vs. Aging		1 <sup>st</sup> year			±1.0	ppm	
<b>Environmental Conditions</b>							
Operating temperature range		-40°C to +85°C					
Storage temperature range		-45°C to +90 °C					