

**TYPICAL CHARACTERISTICS  
ON  
BPF-220M280M-60M-SFF**

**PMI MODEL: BPF-220M280M-60M-SFF IS A BANDPASS FILTER WITH SMA FEMALE CONNECTORS  
IN/OUT. THIS UNIT HAS A PASSBAND FREQUENCY FROM 220 MHz TO 280 MHz.**



**REPORTED AND TESTED BY: V. PRATAP  
DATE: 10/15/2025**

# TYPICAL CHARACTERISTICS ON BPF-220M280M-60M-SFF

## PRODUCT FEATURE

**DESCRIPTION:**

PMI MODEL: BPF-220M280M-60M-SFF IS A BANDPASS FILTER WITH SMA FEMALE CONNECTORS IN/ OUT. THIS UNIT HAS A PASSBAND FREQUENCY FROM 220 MHz TO 280 MHz.

**SPECIFICATIONS:**

- PASSBAND FREQUENCY:..... 220 MHz TO 280 MHz
- BANDWIDTH (-3 dB):..... 60 MHz MIN.
- INSERTION LOSS @ 250 MHz (F<sub>0</sub>):..... 2 dB MAX
- VSWR:..... 1.5:1 MAX
- REJECTION @ 200 MHz:..... 40 dB MIN.
- REJECTION @ 300 MHz:..... 40 dB MIN.
- INPUT POWER:..... 1 W MAX
- CONNECTORS:..... SMA FEMALE
- FINISH:..... PAINTED BLUE

**ENVIRONMENTAL RATINGS:**

- TEMPERATURE:..... -55°C TO +85°C (OPERATING)  
-65°C TO +125°C (STORAGE)
- HUMIDITY:..... MIL-STD-202, METHOD 103B COND. B
- SHOCK:..... MIL-STD-202, METHOD 213B COND. B
- VIBRATION:..... MIL-STD-202, METHOD 204D COND. B
- ALTITUDE:..... MIL-STD-202, METHOD 105C COND. B
- TEMPERATURE CYCLE:..... MIL-STD-202, METHOD 107D COND. A

NOTE: SPECIFICATIONS WILL VARY OVER TEMPERATURE  
NOTE: THE ABOVE SPECIFICATIONS ARE SUBJECT TO CHANGE OR REVISION

ZONE	REV.	DESCRIPTION	DATE	APPROVED
	A1	ORIGINAL RELEASE	9/9/2025	

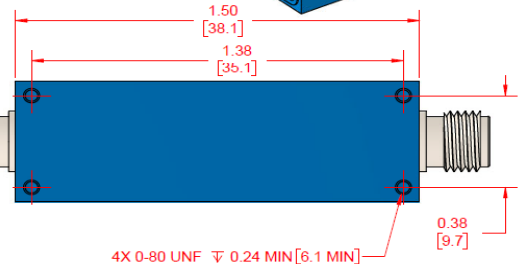
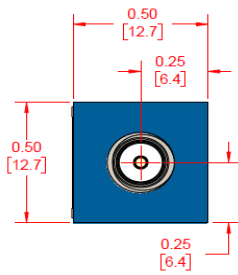
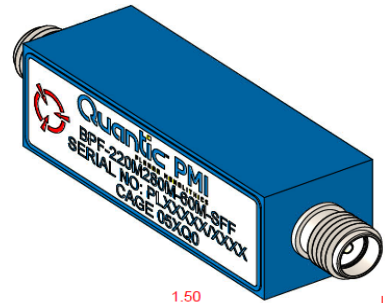

PMI CONFIDENTIAL AND PROPRIETARY

APPROVALS		DATE	TITLE	
DESIGNED BY	V. PRATAP	9/9/2025	OUTLINE	
<small>UNLESS OTHERWISE SPECIFIED: DIMENSIONS ARE IN INCHES TOLERANCES ARE: FRACTIONS DECIMALS ANGLES ° .010 ±.005 °</small>			<small>ISSUE</small> B	<small>FORM NO.</small> 27052800
<small>SCALE</small> 3:1			<small>REV</small> A1	<small>SHEET</small> 1 OF 1

**TYPICAL CHARACTERISTICS  
ON  
BPF-220M280M-60M-SFF**

**PRODUCT SPECIFICATIONS**

TEST ITEM	PARAMETERS	SPECIFIED VALUE	TEST RESULTS		
			-55°C	+25°C	+85°C
1	Passband Frequency Range	220 MHz to 280 MHz	220 MHz to 280 MHz		
2	Bandwidth (-3dB)	60 MHz Min	64 MHz	64 MHz	63.2 MHz
3	Insertion Loss @ 250 MHz	2 dB Max.	1.09 dB	1.29 dB	1.43 dB
4	VSWR	1.5:1 Max.	1.28:1	1.29:1	1.29:1
5	Rejection @ 200 MHz	40 dB Min.	54.4 dB	53 dB	52.4 dB
6	Rejection @ 300 MHz	40 dB Min.	45.5 dB	45.7 dB	45.8 dB
7	Input Power	1W Max.	1W	1W	1W

**TYPICAL CHARACTERISTICS  
ON  
BPF-220M280M-60M-SFF**

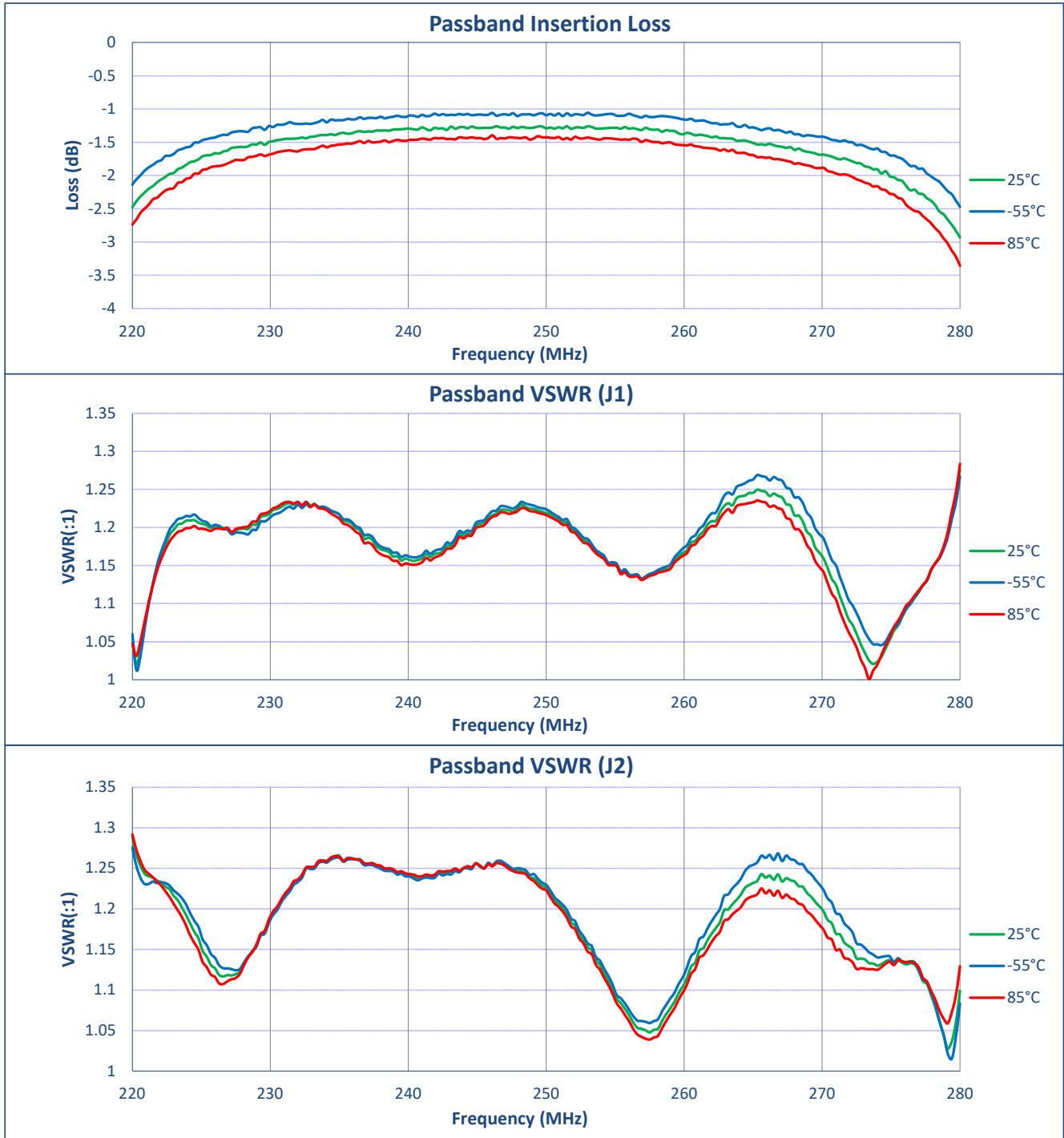

**TYPICAL CHARACTERISTICS  
ON  
BPF-220M280M-60M-SFF**

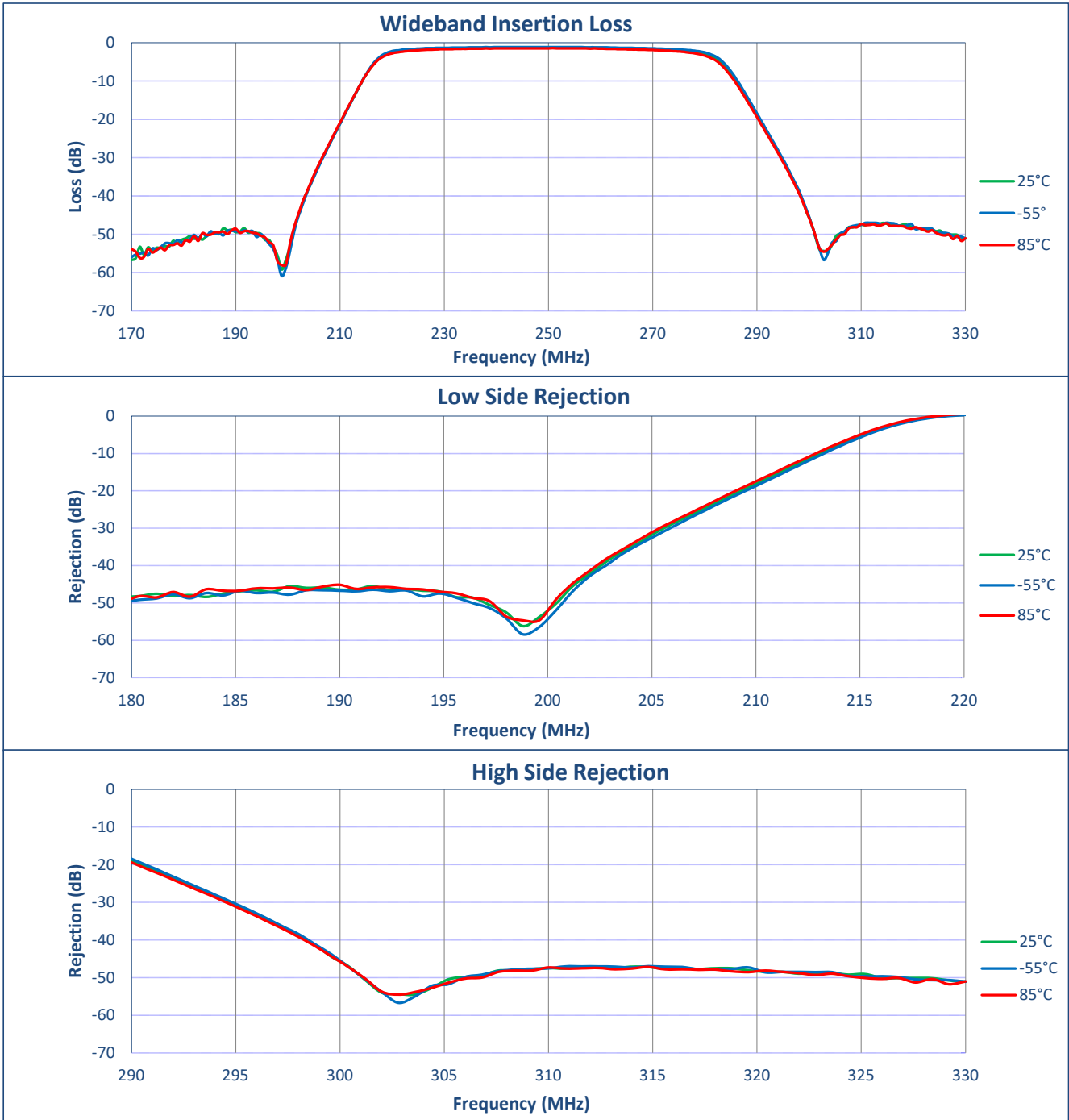

**TYPICAL CHARACTERISTICS  
 ON  
 BPF-220M280M-60M-SFF**

